

INSTRUCTIONS

©Copyright 1996 Teleflex Incorporated (USA)

INSTALLER: THESE INSTRUCTIONS CONTAIN IMPORTANT SAFETY INFORMATION AND MUST BE FORWARDED TO THE BOAT OWNER.

This kit contains the parts required to connect a steering cable to a tiller arm.

WARNING

- BEFORE STARTING INSTALLATION READ THESE INSTRUCTIONS THOROUGHLY. FAILURE TO FOLLOW THESE INSTRUCTIONS OR INCORRECT ASSEMBLY CAN RESULT IN LOSS OF CONTROL AND CAUSE PROPERTY DAMAGE OR INJURY.
- DO NOT SUBSTITUTE PARTS FROM OTHER MANUFACTURERS. THEY MAY CAUSE A SAFETY HAZARD FOR WHICH TELEFLEX INC., USA CANNOT ACCEPT RESPONSIBILITY.
- TO AVOID EXCESSIVE STEERING LOADS, AND TO GET THE BEST STEERING PERFORMANCE, OUTBOARD MOTOR OR OUTDRIVE TRIM TABS AND TILT POSITION MUST BE ADJUSTED AS INSTRUCTED IN THE MOTOR MANUFACTURER'S OPERATION MANUAL. FAILURE TO DO SO CAN AFFECT THE PERFORMANCE OF THE BOAT AND ITS SAFE OPERATION.

PREPARATION FOR INSTALLATION

Before making installation of this kit, the helm and steering cable must be installed following the instructions packed with those components.

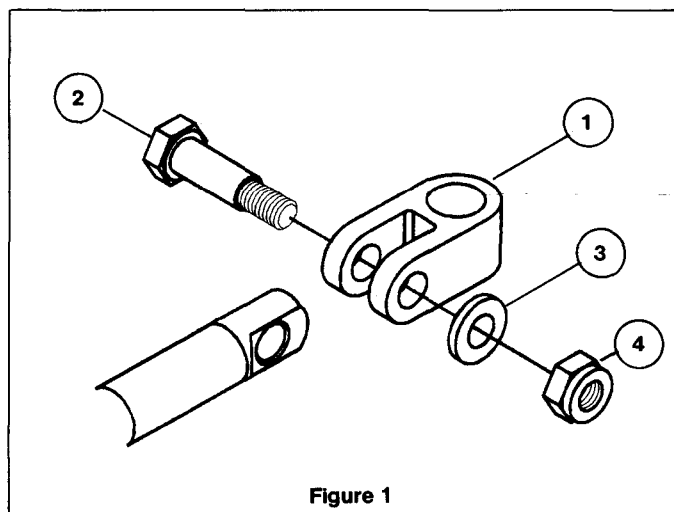

Figure 1

STEP 1. Insert Shoulder Bolt (item 2) thru Clevis (item 1) and steering cable as shown in Figure 1. Place Flat Washer (item 3) on threaded end of shoulder bolt, then thread Locknut (item 4) onto shoulder bolt. Tighten securely.

STEP 2. Place Bushing (item 8) in Clevis (item 1), and insert Bolt (item 5) in clevis, as shown in Figure 2. Place Washer (item 6) onto bolt and insert bolt into tiller arm. Retain in place with Locknut (item 7), tighten securely.

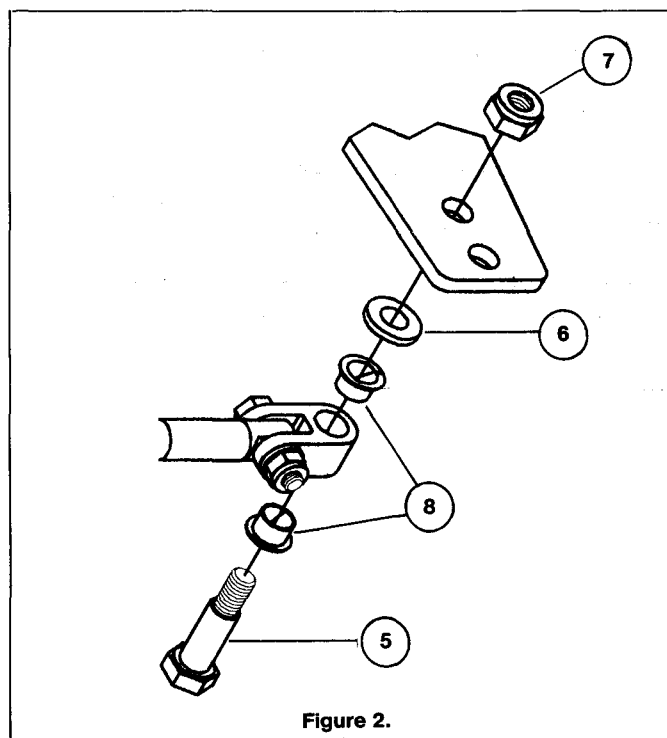

Figure 2.

NOTE: If tiller arm has more than one hole, use the one closest to the motor or pivot.

STEP 3. Lubricate all moving parts with a coating of light weight waterproof grease.

CAUTION

MAKE SURE THE CLEVIS OPERATES FREELY AND CAUSES NO INTERFERENCE. IF SUCH A CONDITION IS NOTED, IT MUST BE CORRECTED.

PARTS LIST

ITEM	DESCRIPTION	QTY
1	Clevis	1
2	Shoulder Bolt 5/16-18 x 1-5/32	1
3	Flat Washer 5/16 ID	1
4	Lock Nut 5/16-18	1
5	Shoulder Bolt 3/8-24	1
6	Flat Washer 3/8 ID	1
7	Lock Nut 3/8-24	1
8	Bushing	2

MAINTENANCE NOTES

1. After a few hours of operation and at frequent intervals thereafter, check all fasteners and the complete system for security and integrity.

DANGER

LOOSENING OR LOSS OF ONE OR MORE FASTENERS MAY CAUSE FAILURE OF THE STEERING SYSTEM, RESULTING IN LOSS OF STEERING CONTROL AND COULD CAUSE PERSONAL INJURY OR PROPERTY DAMAGE.

DANGER

DO NOT COVER CRACKS WITH TAPE OR OTHER SEALANTS, THIS WILL CREATE A HAZARD IN WHICH THE CABLE CAN FAIL SUDDENLY WITHOUT WARNING.

2. Keep all moving parts free from build-up of salt and other foreign material. This will affect their operation and create steering problems.

3. Inspect periodically for corrosion. Any parts affected by corrosion must be replaced. When replacing hardware, self-locking hardware must be used.

4. Inspect steering cable periodically for cracks or other damage. If any is found the cable must be replaced.

KEEP THESE INSTRUCTIONS WITH YOUR BOAT FOR FUTURE REFERENCE.